

BASEMENT FLOOR PLAN
 SCALE: 1/4" = 1'-0"
 154 SQ. FT. 3RD LEVEL
 621 SQ. FT. UNFIN. CRAWLSPACE

GENERAL NOTES:
 -ALL WINDOWS TO BE THERMOTECH (GRIDS OPTIONAL)
 -42" MIN. FROST DEPTH REQ'D • ALL NON HEATED FROST FOOTINGS
 -REINFORCEMENT OF FND, WALLS AS PER LOCAL CODE
 -SOLID BEARING REQ'D • ALL BEAMS • HEADERS
 -SAFETY GLAZING REQ'D FOR ALL GLASS WITHIN 24" ARC OF DOORS
 -SAFETY GLAZING REQ'D FOR ALL WINDOWS WITHIN 18" OF FLOOR SURFACE
 -ALL STOOLS TO BE LOCATED IN A 30" CLEAR SPACE WIDTH
 -8000 PSI CONC. FOOTINGS

* NOTE: ALL DIMENSIONING IS TO EXTERIOR OF CONC. BLOCK.

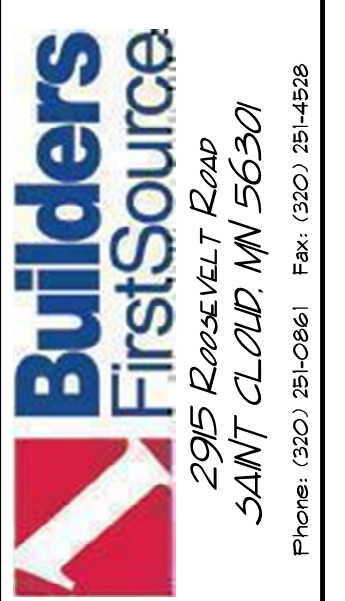

Date:	3/1/24
Revised:	
Revised:	
Revised:	
Revised:	
Revised:	
Revised:	
Plan Number:	1092334
Page Number:	2 of 3

Customer Signature _____ Date _____
 These general drawings have been prepared using information provided by the customer and it is the responsibility of the customer to verify the accuracy of the information provided. The drawings are not a substitute for a contract or any other legal document. Before starting construction the customer should contact a contractor or architect to verify the drawings. The drawings are not intended to be used for any other purpose. The customer is responsible for obtaining all necessary permits and approvals. The drawings are not intended to be used for any other purpose. The customer is responsible for obtaining all necessary permits and approvals. The drawings are not intended to be used for any other purpose. The customer is responsible for obtaining all necessary permits and approvals.

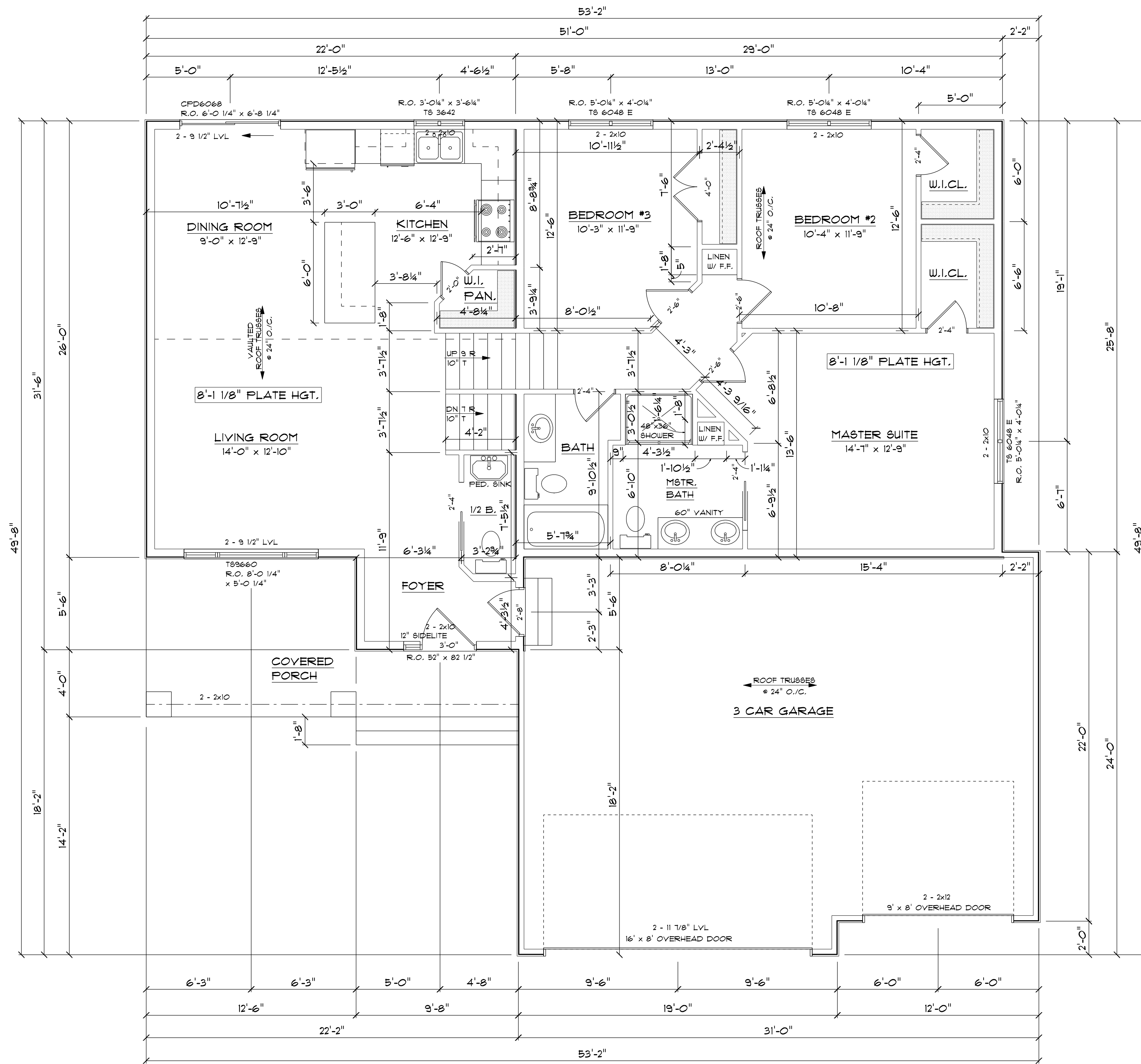

MAIN FLOOR PLAN

SCALE: 1/4" = 1'-0"
 1381 SQ. FT. MAIN FLOOR
 109 SQ. FT. GARAGE
 151 SQ. FT. COV. PORCH

* NOTE: ALL DIMENSIONING IS TO EXTERIOR OF 1/2" SHEATHING.

GENERAL NOTES:
 -8'-1 1/8" PLATE HGT. UNLESS NOTED
 -ALL WINDOWS TO BE THERMOTECH (GRIDS OPTIONAL)
 -SAFETY GLAZING REQ'D FOR ALL GLASS WITHIN 24" ARC OF DOORS
 -SAFETY GLAZING REQ'D FOR ALL WINDOWS WITHIN 18" OF FLOOR SURFACE & GREATER THAN 9 SQ.FT. IN AREA
 -SOLID BEARING REQ'D @ ALL BEAMS & HEADERS
 -ALL STOOLS TO BE LOCATED IN A 30" CLEAR SPACE WIDTH

Date:	3/1/24
Revised:	
Revised:	
Revised:	
Revised:	
Revised:	
Revised:	
Plan Number:	1092334
Page Number:	3 of 3

Builders FirstSource
 2915 Rockwell Road
 SAINT CLOUD, MN 56301
 Phone: (320) 251-0861 Fax: (320) 251-4528

Customer Signature _____ Date _____
 These general drawings have been prepared using information provided by the customer and it is the responsibility of the customer to verify the accuracy of the information provided. The drawings are not a substitute for a contract or any other legal document. Before starting construction the customer should consult a contractor or architect. The project is subject to change without notice. The customer is responsible for obtaining all necessary permits. General, local building officials to determine if a building permit is required. We assume no responsibility for claims or damages arising from errors, omissions, or omissions of detail of the drawings.